

Please read this user manual carefully, it contains instructions for the correct assembly of the KIT.
Please refer to the website www.goblin-helicopter.com for updates and other important information. Thanks You. 

Battery Quick Release Assembly

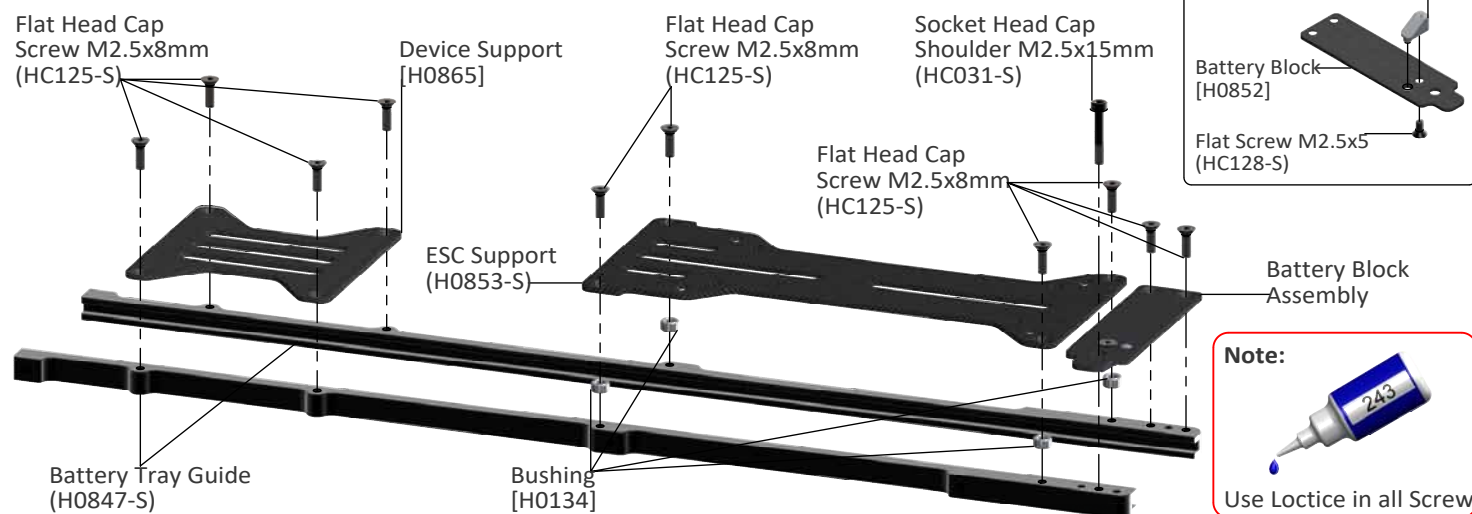

Main Frame Assembly

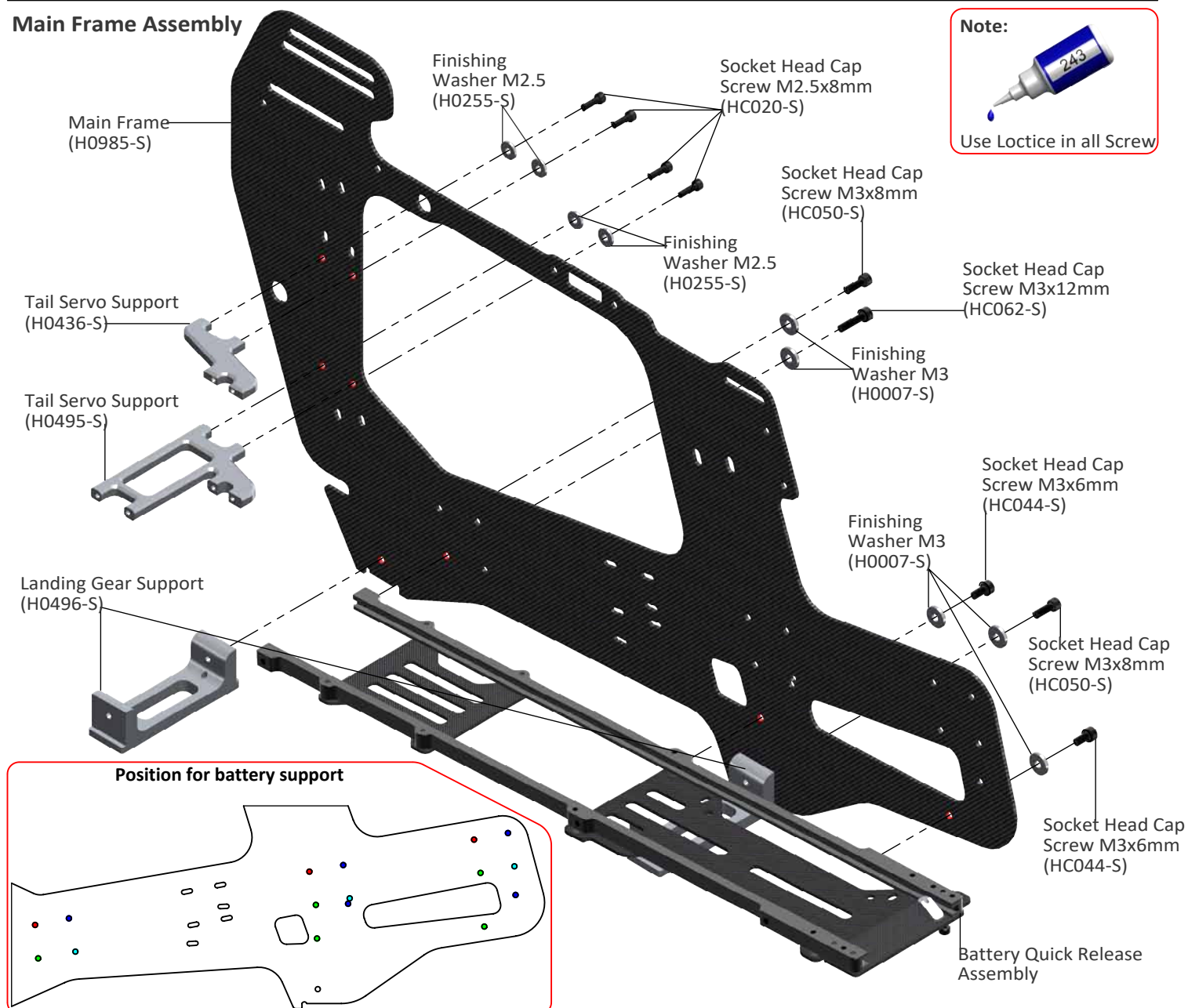

New Center Hub Assembly

The HF3C head should be assembled with 1 Damper 90 shore + 2 Damper 70 Shore on each side (please check pic)

In the Kit you can find more Damper 70/90 shore for optimize your model in accordong with your setup/preference

The HF3C head should be assembled with one, 1mm shim (HC230) and one, 0.2mm shim (HC232) on each side.

The blade grips must move freely, but they should not move just under their own weight.

If the blade grips are too tight, you can remove the 0.2mm shim (HC232) from each side.

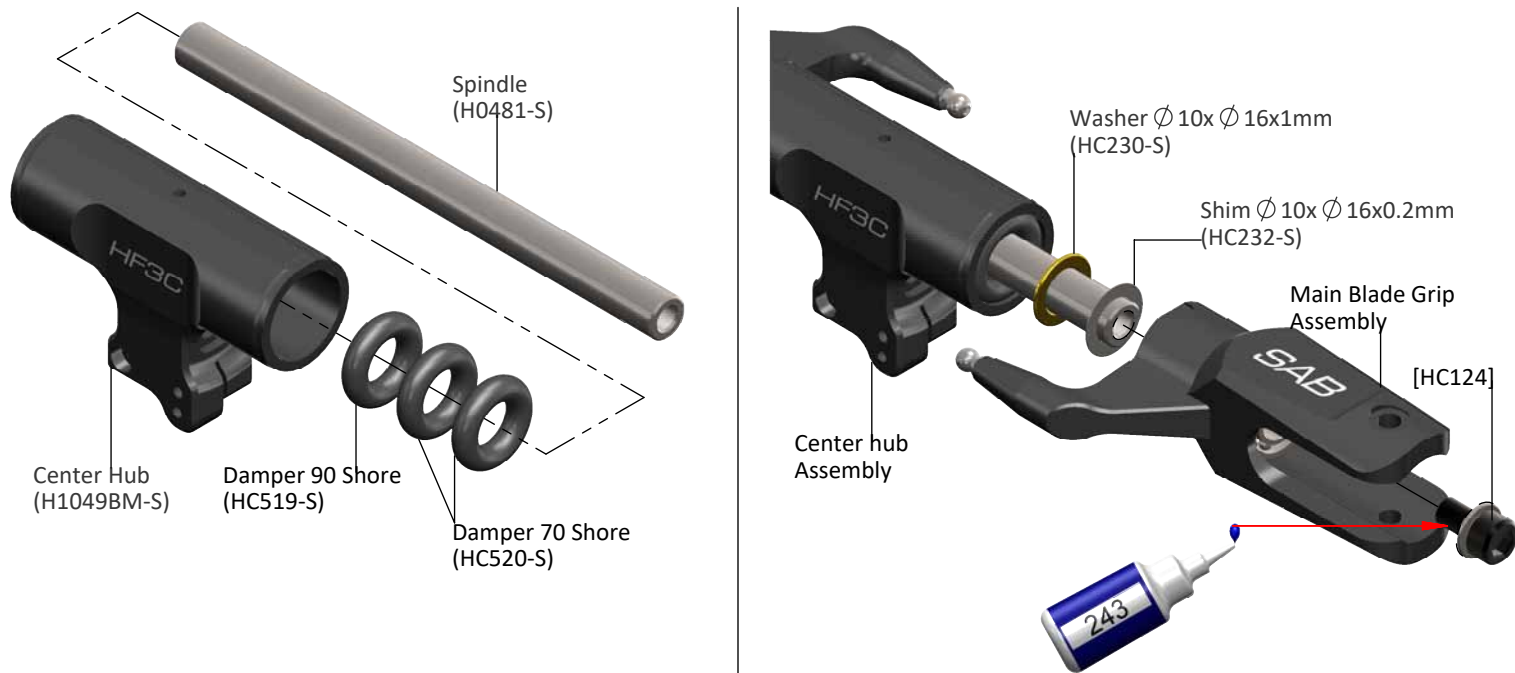

SPARE PART

Battery Quick Release [H0847-S]

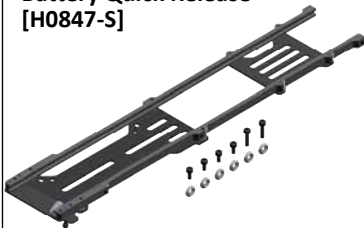

- 1 x Battery Quick Release SET.

Main Frame [H0985-S]

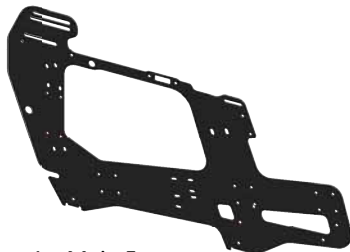

- 1 x Main Frame.

Canopy Urukay WC [H0974-S]



- 1 x Canopy Urukay WC.

Boom Urukay WC [H0975-S]



- 1 x Boom Urukay WC.

HF3C Center Hub [H1094BM-S]



- 1 x HF3C Center Hub HF3C.
 - 1 x Shoulder Cap Screw M4x24.
 - 1 x Metric Hex Nylon Nuts M4.
 - 2 x Socket Head Cap M3x12.

Damper 90 Shore [HC519-S]

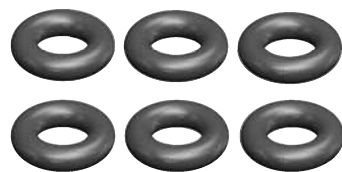

- 6 x Damper 90 Shore.

Damper 70 Shore [HC520-S]



- 6 x Damper 70 Shore.

Blades 730WC



- 2 x Main Blades 730WC.